

Soils Map

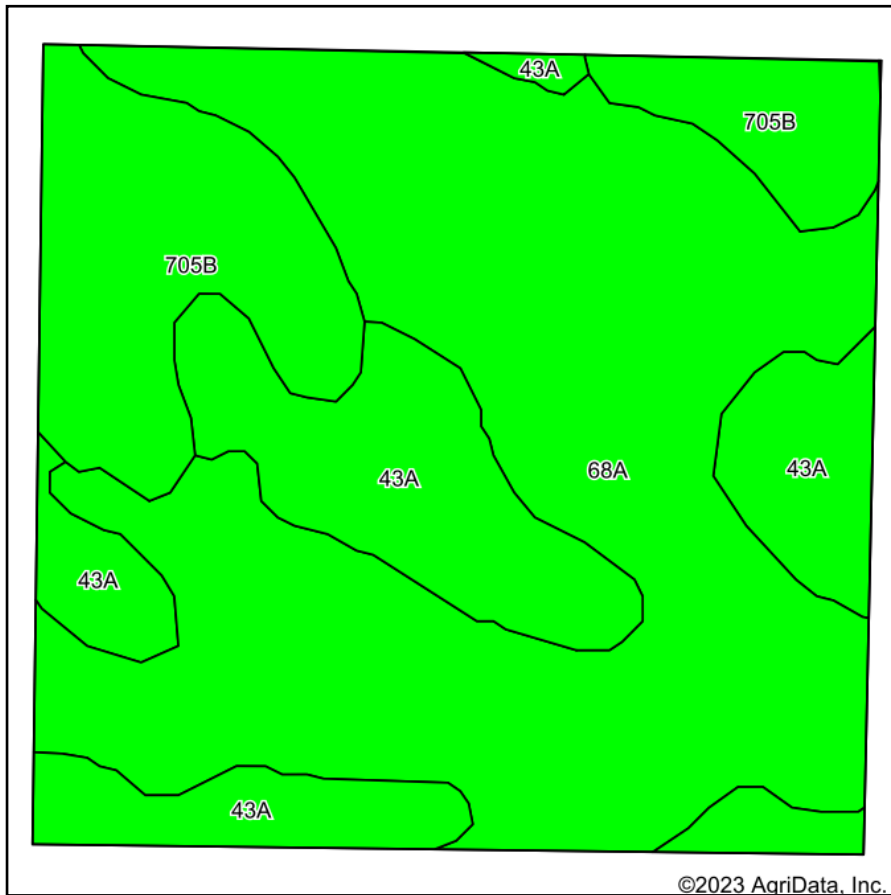

Soils data provided by USDA and NRCS.

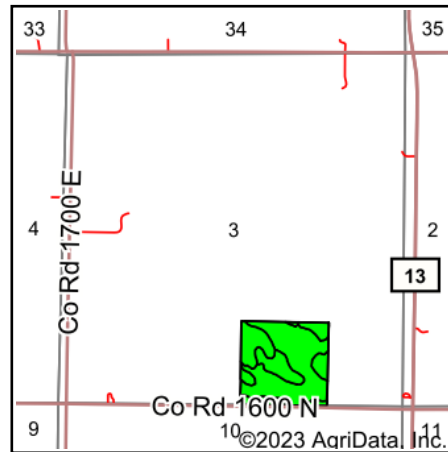

State: **Illinois**
 County: **Woodford**
 Location: **3-27N-1W**
 Township: **Roanoke**
 Acres: **40.2**
 Date: **7/17/2023**

Maps Provided By:



Area Symbol: IL203, Soil Area Version: 19									
Code	Soil Description	Acres	Percent of field	Il. State Productivity Index Legend	Subsoil rooting ^a	Corn Bu/A	Soybeans Bu/A	Wheat Bu/A	Crop productivity index for optimum management
68A	Sable silty clay loam, 0 to 2 percent slopes	23.11	57.5%		FAV	192	63	74	143
43A	Ipava silt loam, 0 to 2 percent slopes	9.86	24.5%		FAV	191	62	77	142
**705B	Buckhart silt loam, 2 to 5 percent slopes	7.23	18.0%		FAV	**188	**60	**73	**141
Weighted Average						191	62.2	74.6	142.4

Table: Optimum Crop Productivity Ratings for Illinois Soil by K.R. Olson and J.M. Lang, Office of Research, ACES, University of Illinois at Champaign-Urbana. Version: 1/2/2012 Amended Table S2 B811

Crop yields and productivity indices for optimum management (B811) are maintained at the following NRES web site: <http://soilproductivity.nres.illinois.edu/>

** Indexes adjusted for slope and erosion according to Bulletin 811 Table S3

^a UNF = unfavorable; FAV = favorable

Soils data provided by USDA and NRCS. Soils data provided by University of Illinois at Champaign-Urbana.