

# Soils Map

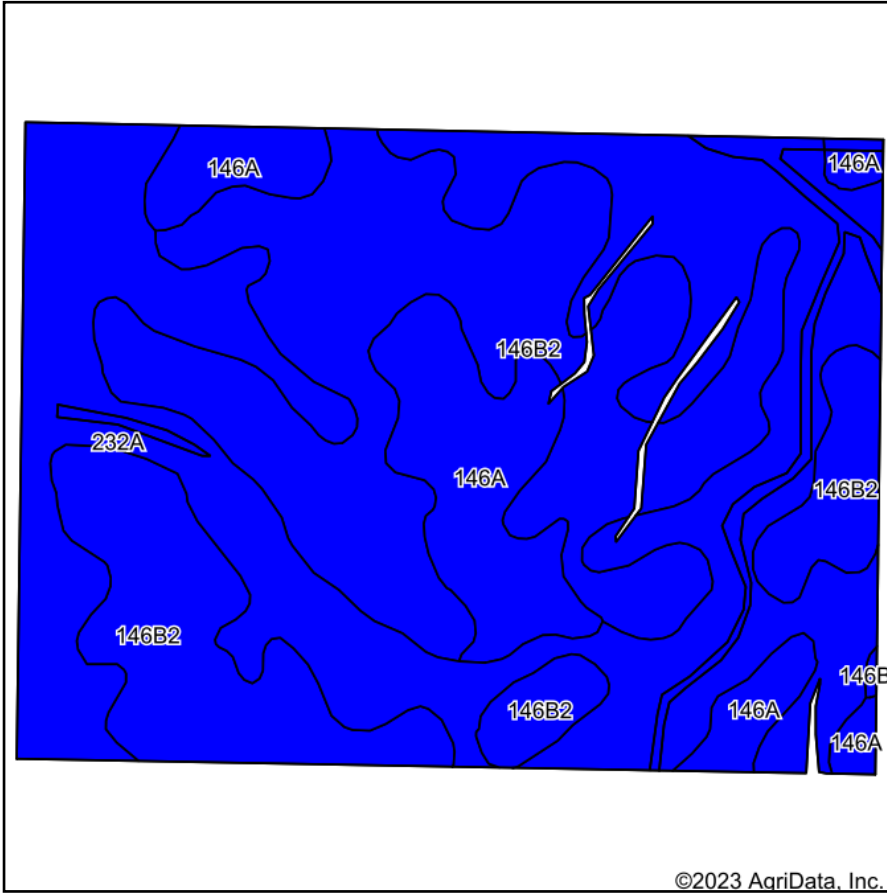

Soils data provided by USDA and NRCS.

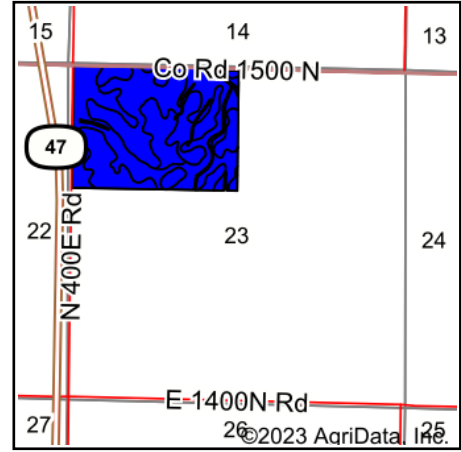

State: **Illinois**  
 County: **Ford**  
 Location: **23-25N-7E**  
 Township: **Sullivant**  
 Acres: **118.1**  
 Date: **3/14/2023**

Maps Provided By:



Area Symbol: IL053, Soil Area Version: 18

Code	Soil Description	Acres	Percent of field	Il. State Productivity Index Legend	Subsoil rooting <i>a</i>	Corn Bu/A	Soybeans Bu/A	Wheat Bu/A	Crop productivity index for optimum management
**146B2	Elliott silty clay loam, 2 to 4 percent slopes, eroded	52.80	44.7%		FAV	**160	**52	**65	**119
232A	Ashkum silty clay loam, 0 to 2 percent slopes	50.33	42.6%		FAV	170	56	65	127
146A	Elliott silt loam, 0 to 2 percent slopes	14.97	12.7%		FAV	168	55	68	125
<b>Weighted Average</b>						<b>165.3</b>	<b>54.1</b>	<b>65.4</b>	<b>123.2</b>

**Table: Optimum Crop Productivity Ratings for Illinois Soil by K.R. Olson and J.M. Lang, Office of Research, ACES, University of Illinois at Champaign-Urbana.** Version: 1/2/2012 Amended Table S2 B811

Crop yields and productivity indices for optimum management (B811) are maintained at the following NRES web site: <http://soilproductivity.nres.illinois.edu/>

\*\* Indexes adjusted for slope and erosion according to Bulletin 811 Table S3

*a* UNF = unfavorable; FAV = favorable

Soils data provided by USDA and NRCS. Soils data provided by University of Illinois at Champaign-Urbana.