

Soils Map

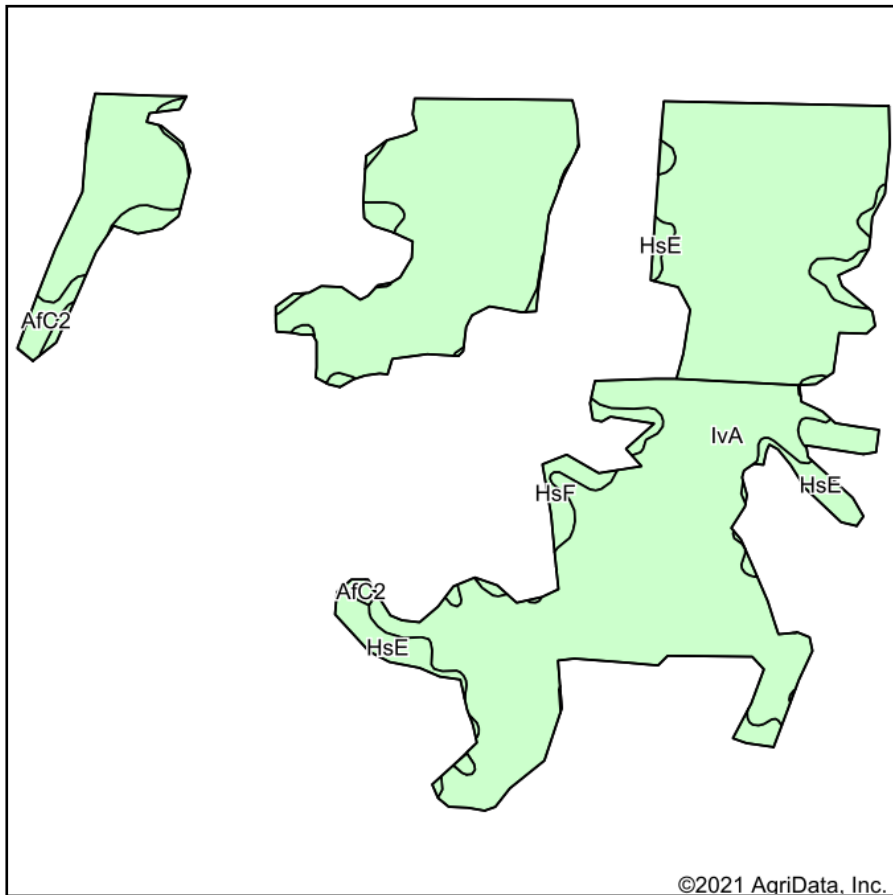

Soils data provided by USDA and NRCS.

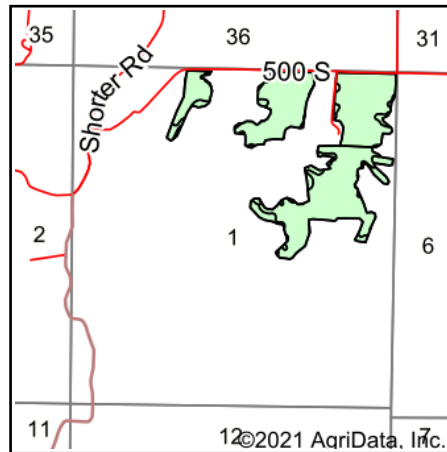

State: **Indiana**
 County: **Parke**
 Location: **1-14N-7W**
 Township: **Raccoon**
 Acres: **88.84**
 Date: **8/24/2021**



Area Symbol: IN121, Soil Area Version: 24

Code	Soil Description	Acres	Percent of field	Non-Irr Class	Corn	Soybeans	*n NCCPI Overall
IvA	Iva silt loam, 0 to 2 percent slopes	78.87	88.8%	IIw	164	54	89
HsE	Hickory complex, 15 to 30 percent slopes	5.50	6.2%	VIe	99	34	69
HsF	Hickory complex, 30 to 70 percent slopes	3.44	3.9%	VIIe			19
Afc2	Alford silt loam, 6 to 12 percent slopes, eroded	1.03	1.2%	IIIe	155	54	87
Weighted Average					153.5	50.7	*n 85

*n: The aggregation method is "Weighted Average using all components"
 Soils data provided by USDA and NRCS.