

THE LORANDA GROUP, INC.
Agricultural Real Estate Brokerage, Auctions, Acquisitions, & Consulting



TENANT REIMBURSEMENT

Iowa JARD Farmland Auction

November 9, 2021

After harvest in 2020, the farm tenant applied fertilizer and lime on part of the Jard Farm to prepare for the 2021 – 2024 crop years. Following is a summary for the amount that will be due to Doug Petersen at the closing of the 349 acres.

Tract 1: No reimbursement due.

Tract 2: On 10/21/2020, the farm tenant applied the fertilizer listed below for the 2021 and 2022 crop years. The reimbursement amount would be what was applied for 2022.

MAP 11-52-0 Bulk:	173#'s/Acre	@ \$430.00/Ton x 123 tillable acres =	4,575.20/2 =	2,287.60
Potash 0-0-60 Bulk:	200#'s/Acre	@ \$340.00/Ton x 123 tillable acres =	4,182.00/2 =	2,091.00
Nutrient Stewardship Initiative		@ \$1.00/Ton x 22.94 tons =	22.94/2 =	11.47
Dry Application Spinner:		@ \$5.50/Acre x 123 tillable acres =	676.50/2 =	<u>338.25</u>

TRACT 2 TOTAL: \$4,728.32

Tract 3: On 10/21/2020, the farm tenant applied the fertilizer listed below for the 2021 and 2022 crop years, and the lime for the 2021 – 2024 crop years. The reimbursement amount would be what was applied for 2022 - 2024.

MAP 11-52-0 Bulk:	173#'s/Acre	@ \$430.00/Ton x 33 tillable acres =	1,227.65/2 =	613.83
Potash 0-0-60 Bulk:	200#'s/Acre	@ \$340.00/Ton x 33 tillable acres =	1,122.00/2 =	561.00
Nutrient Stewardship Initiative		@ \$1.00/Ton x 6.55 tons =	6.16/2 =	3.08
Dry Application Spinner:		@ \$5.50/Acre x 33 tillable acres =	181.50/2 =	90.75
Lime Bulk:	1.1 Tons/Acre	@ \$17.99/Ton x 134.6 tillable acres =	2,664.32/1.33 =	1998.74
VRT Application:		@ \$4.30/Acre x 134.6 tillable acres =	578.78/1.33 =	434.19

TRACT 3 TOTAL: \$3,701.59

Fertilizer

Gold Star FS, Inc - Woodhull Crops

2136 E 490 ST
Alpha IL 61413

(309) 334-2111 Fax: 309-334-3271

EAST 33 Acres EAST
Invoice side Across Road 82011215

Invoice Date 10/30/2020
Due Date 01/25/2021

Customer ID 0513650

Salesperson 0075
Shipping Loc. 082

Acres 33
Ticket(s) 82008054

ENLIST-BEANS

DOUG PETERSON
6122 N 400 AVE
ALPHA, IL 61413

Comments: Dry Fertilizer on Iowa Jard DC1

Quantity	Description	Unit Price	Total \$
5710.000 Lb	Bulk MAP 11-52-0	430.00 /TN	1,227.65
6600.000 Lb	Potash 0-0-62 Bulk White	340.00 /TN	1,122.00
33.000 AC	* App - Dry	5.50 /AC	181.50
6.155 TN	Nutrient Stewardship Initiative	1.00 /TN	6.16

2 years of fertilizer on DC1 - 30 acres
Used 1 year - owe for 1 year
Iowa Jard \$1268.66

Terms: A FINANCE CHARGE of 1.8% per month which is equivalent to 21.6% PER YEAR PERCENTAGE RATE (APR) shall be added 30 days after statement date.

Sub Total 2,537.31

Amount Due 2,537.31

Remit To: Gold Star FS, Inc
PO Box 135
Cambridge IL 61238
Phone #: 309-937-3369

DOUG PETERSON
Pesticide # Mike Diffenbaugh CO73373 Exp. Date 12/31/2020

Invoice

82011215

Star FS, Inc - Woodhull Crops

136 E 490 ST
Alpha, IL 61413 / (309) 334-2111

DOUG PETERSON
309-334-2325

Bill To: 6122 N 400 AVE
ALPHA, IL 61413

Field ID: 0513650 / DC1
Description: Iowa Jard Farm
Ship To: 6122 N 400 AVE
ALPHA, IL 61413

Consolidated Blend 82008054

Not Loaded Custom Applied
Salesperson: 0075
Ordered Date: 10/21/2020
Time: 3:54 PM
Loaded Date:
Crop: ENLIST-BEANS
Acre: 33
Placement: Dry Custom
Applicator:
Vehicle ID:

Comments: Dry Fertilizer on Iowa Jard DC1

Product	EPA Registration #	Rate/Acre	Total
Bulk MAP 11-52-0		173.000 Lb	5710.000 Lb
Potash 0-0-62 Bulk White		200.000 Lb	6600.000 Lb
App - Dry		1.000 AC	33.000 AC

Lbs	N	P	K	S	UD	Ca	Mg	Zn	Fe	Mn	Cu	B
Order.	0	0	0									
Blend.	19	89	124									
Analys.	5	24	33									

Lbs/Acre: 373	Lbs/Cu Ft: 66.05	Cu Ft/Acre: 5.647	Lbs/Batch: 12309	Acre/Batch: 33.000
---------------	------------------	-------------------	------------------	--------------------

1 Total Batches

Total Product Blended = 12310 lbs

This ticket is shared with:

	Regular	S-2	S-3
DOUG PETERSON	100.0000	100.0000	100.0000
IOWA JARD CORP			

Diffy
77

Received by: _____ Date: _____

Location: Alwood
Customer: Peterson, Doug
Date: 2020-10-14

Farm: Iowa Jard Farm
Field: DC1
Acres: 31.67

Phosphorus (lb/ac)

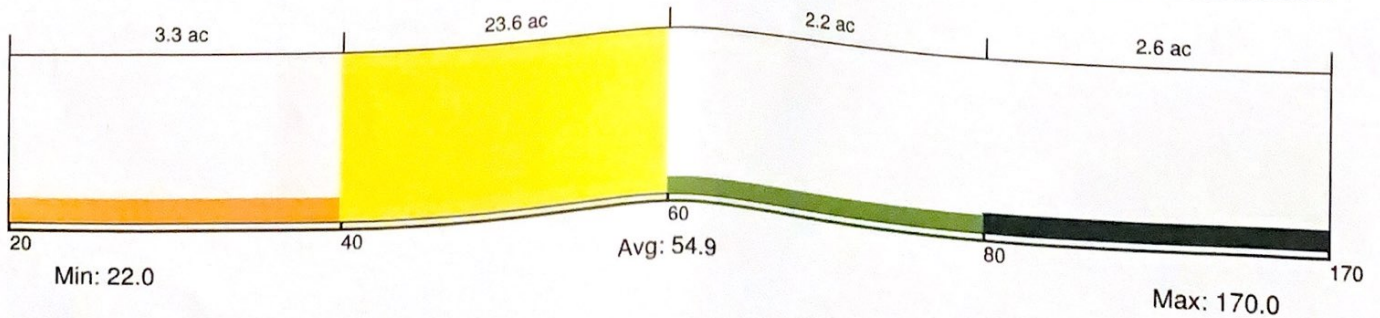
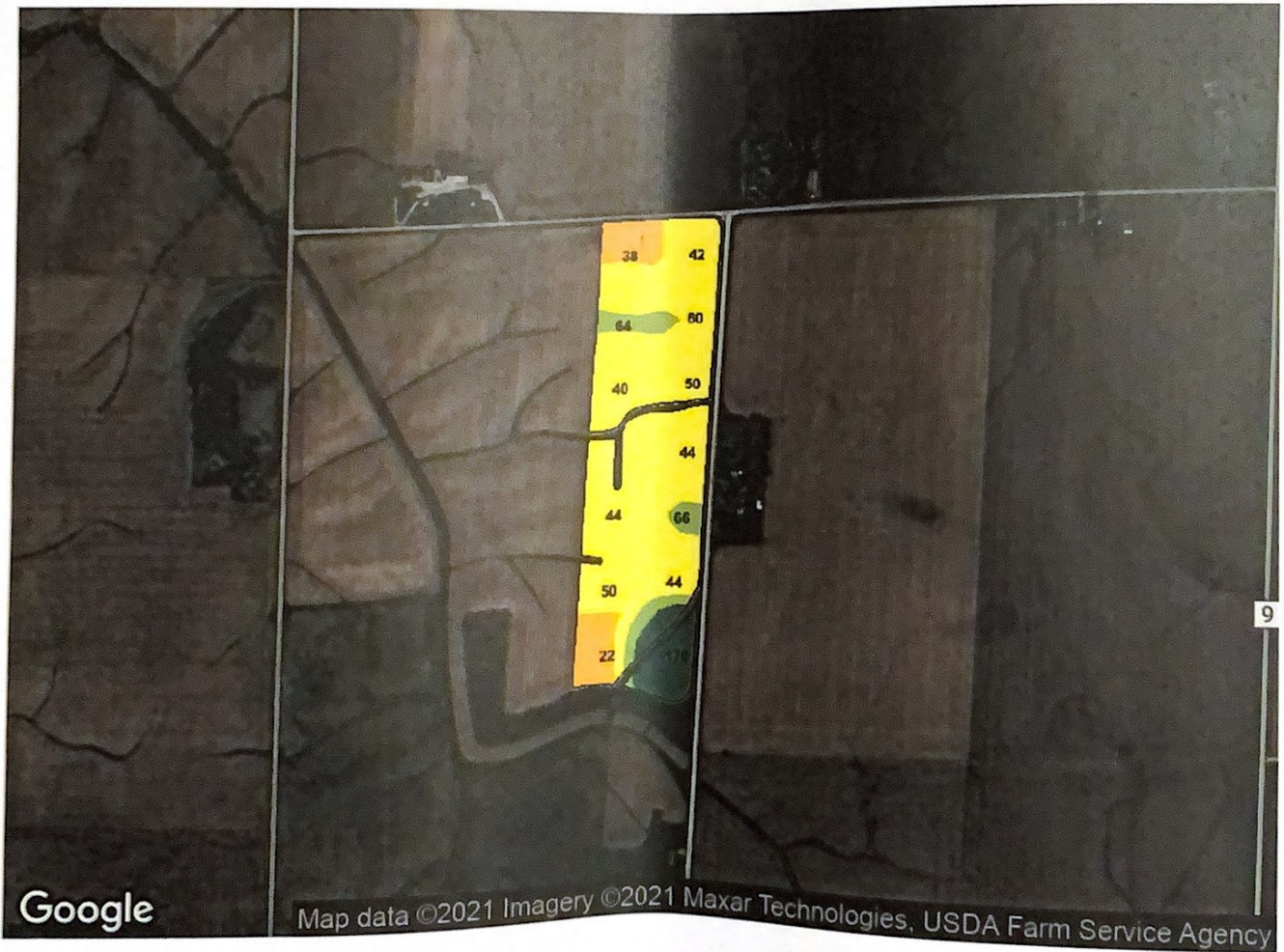

Location: Alwood
Customer: Peterson, Doug
Date: 2020-10-14

Farm: Iowa Jard Farm
Field: DC1
Acres: 31.67

pH

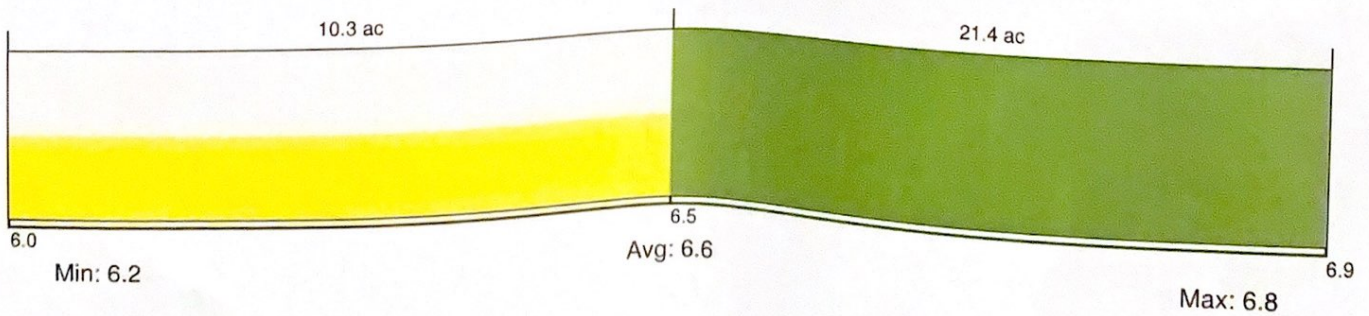
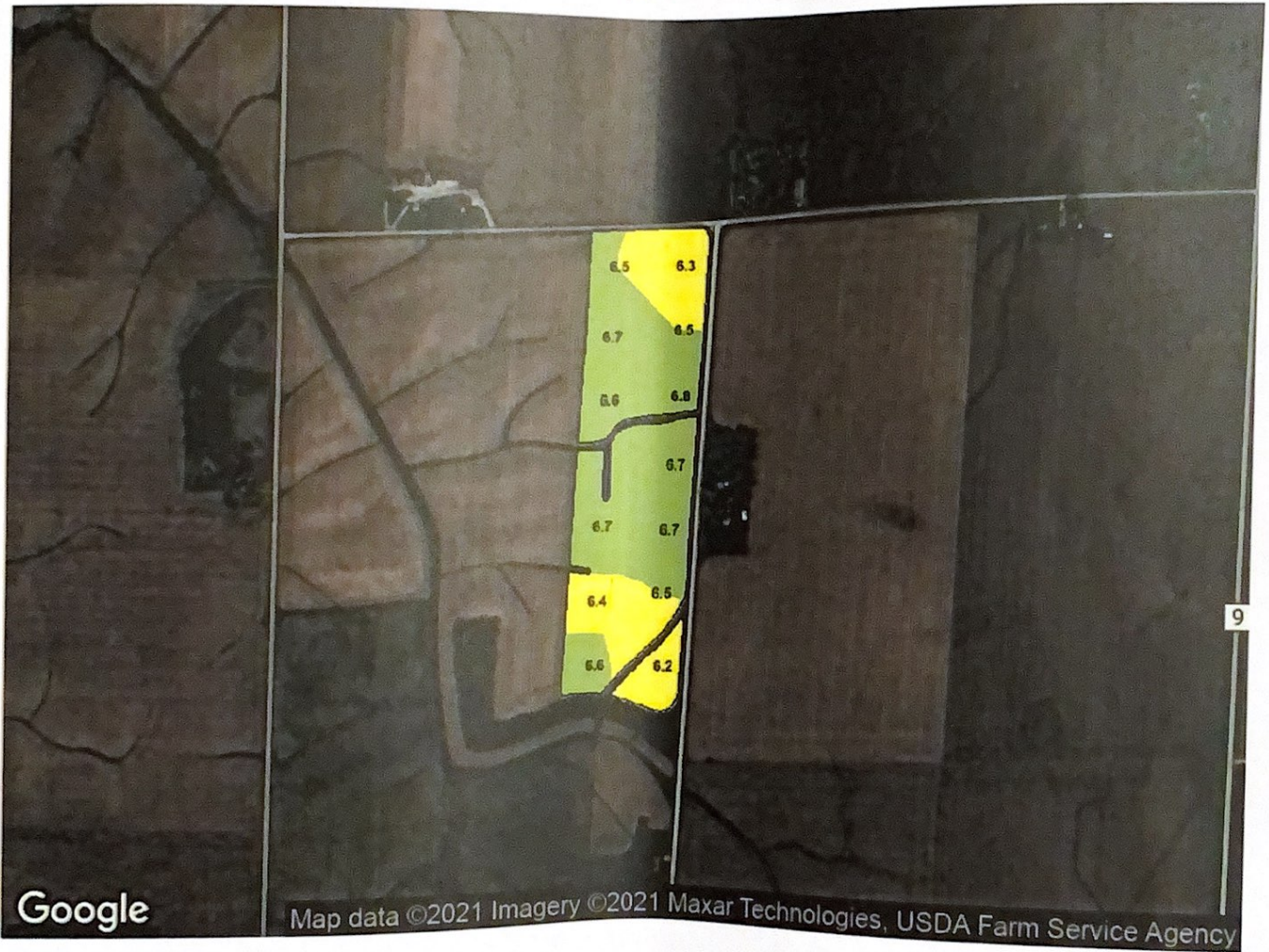

Data Analysis Report

Location: Alwood
Customer: Peterson, Doug
Date: 2020-10-14

Farm: Iowa Jard Farm
Field: DC1
Acres: 31.67

Cation Exchange Capacity

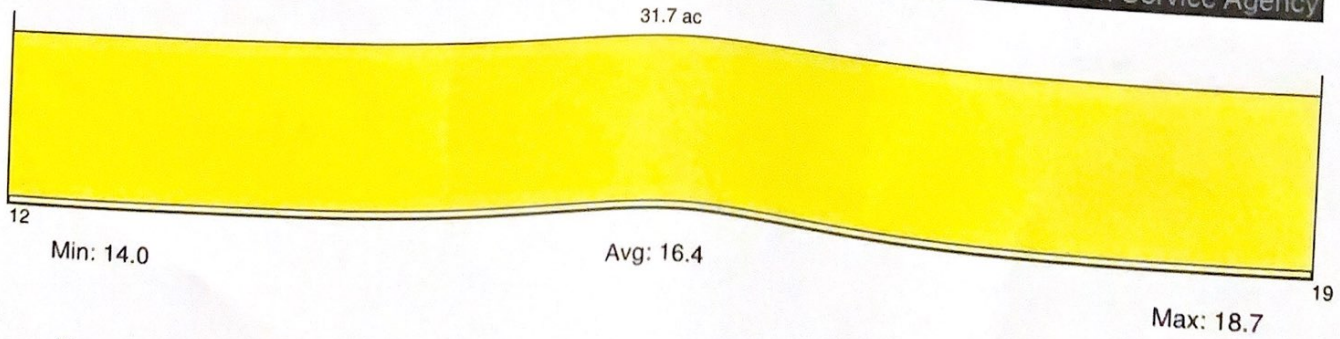
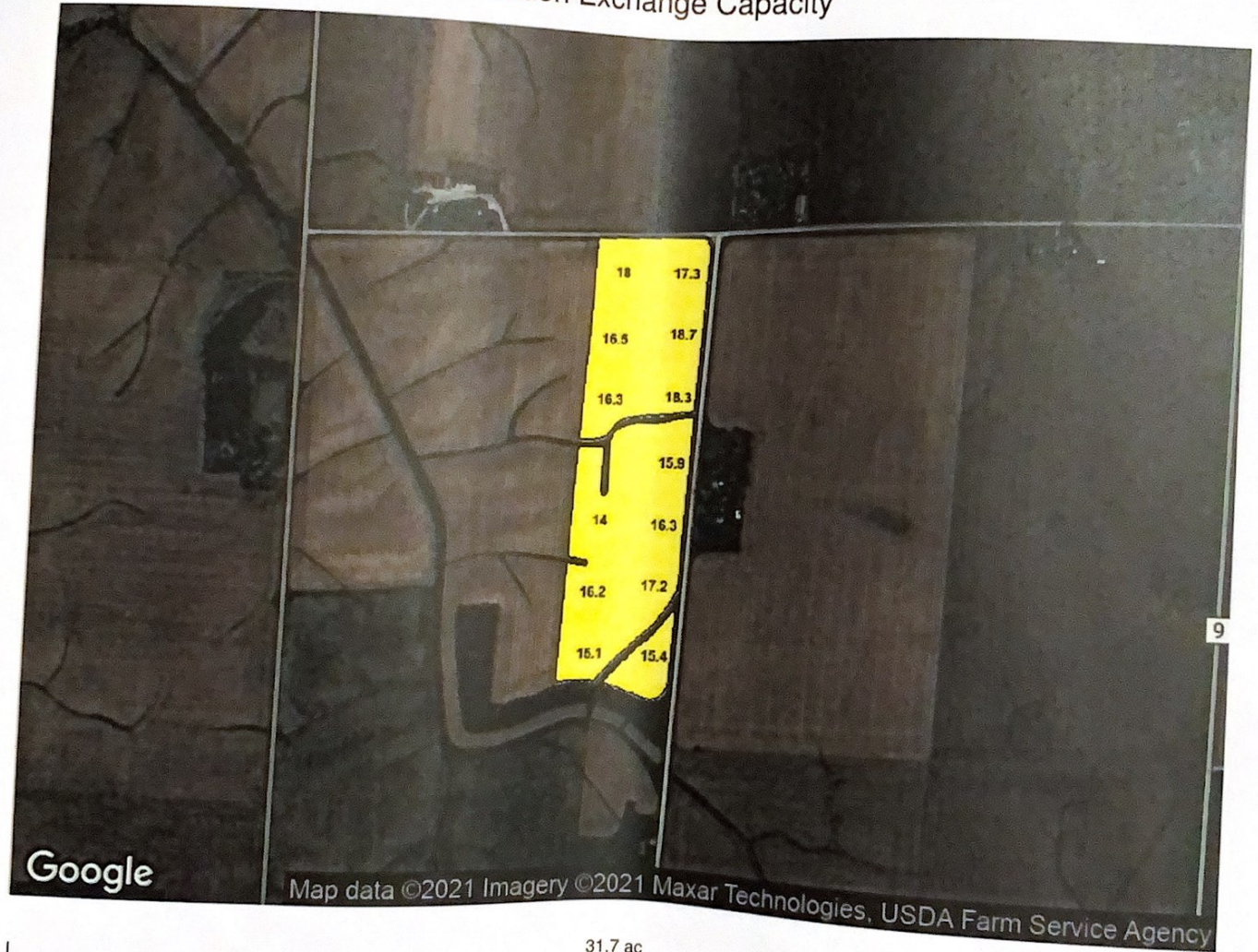

Pesticide #

Location: Alwood
Customer: Peterson, Doug
Date: 2020-10-14

Farm: Iowa Jard Farm
Field: DC1
Acres: 31.67

Organic Matter

