

Soils Map

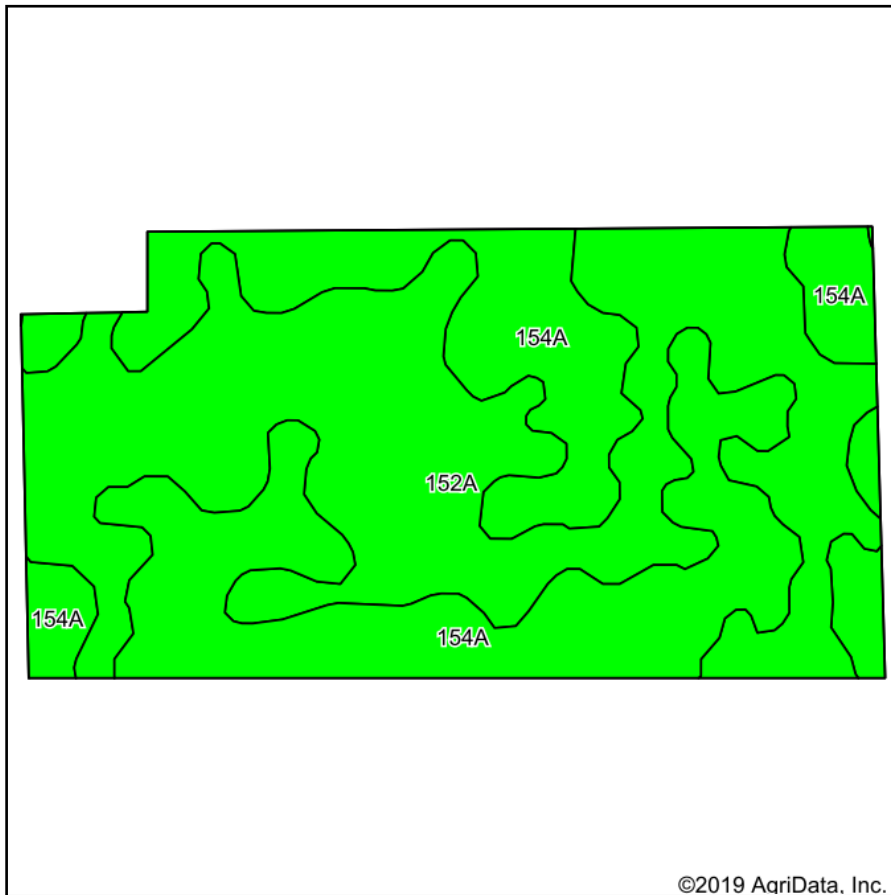

Soils data provided by USDA and NRCS.

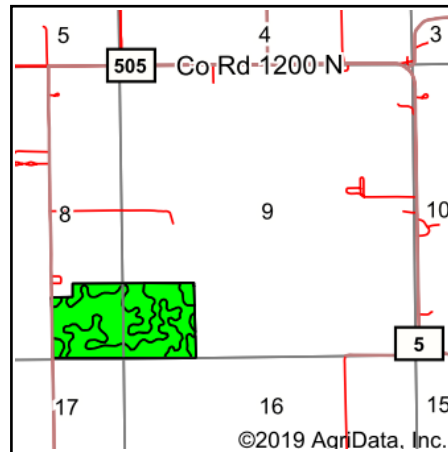

State: **Illinois**
 County: **Vermilion**
 Location: **9-18N-11W**
 Township: **Georgetown**
 Acres: **79.81**
 Date: **10/20/2019**

Maps Provided By:

 CUSTOMIZED ONLINE MAPPING
 © AgriData, Inc. 2019 www.AgriDataInc.com

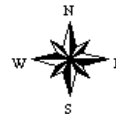

| Area Symbol: IL183. Soil Area Version: 14 | | | | | | | |
|---|--|-------|------------------|-------------------------------------|--------------|---------------|--|
| Code | Soil Description | Acres | Percent of field | Il. State Productivity Index Legend | Corn Bu/A | Soybeans Bu/A | Crop productivity index for optimum management |
| 152A | Drummer silty clay loam, 0 to 2 percent slopes | 41.51 | 52.0% | | 195 | 63 | 144 |
| 154A | Flanagan silt loam, 0 to 2 percent slopes | 38.30 | 48.0% | | 194 | 63 | 144 |
| Weighted Average | | | | | 194.5 | 63 | 144 |

Table: Optimum Crop Productivity Ratings for Illinois Soil by K.R. Olson and J.M. Lang, Office of Research, ACES, University of Illinois at Champaign-Urbana. Version: 1/2/2012 Amended Table S2 B811

Crop yields and productivity indices for optimum management (B811) are maintained at the following NRES web site: <http://soilproductivity.nres.illinois.edu/>

** Indexes adjusted for slope and erosion according to Bulletin 811 Table S3

Soils data provided by USDA and NRCS. Soils data provided by University of Illinois at Champaign-Urbana.