

# Soils Map

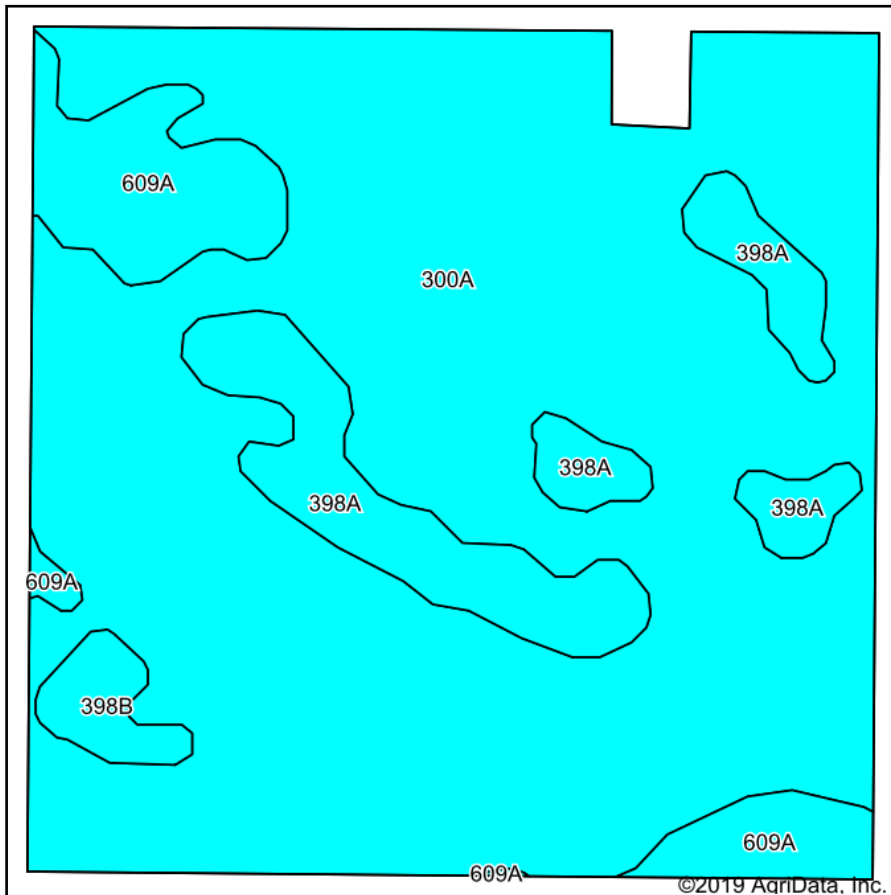

Soils data provided by USDA and NRCS.

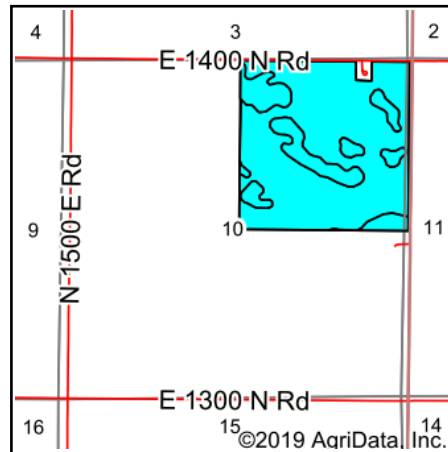

State: **Illinois**  
 County: **Livingston**  
 Location: **10-27N-5E**  
 Township: **Eppards Point**  
 Acres: **156.69**  
 Date: **6/7/2019**

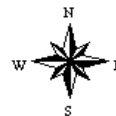

Area Symbol: IL105, Soil Area Version: 13							
Code	Soil Description	Acres	Percent of field	Il. State Productivity Index Legend	Corn Bu/A	Soybeans Bu/A	Crop productivity index for optimum management
300A	Westland clay loam, 0 to 2 percent slopes	125.72	80.2%		164	53	121
398A	Wea loam, 0 to 2 percent slopes	16.18	10.3%		176	55	130
609A	Crane loam, 0 to 2 percent slopes	12.12	7.7%		169	53	124
**398B	Wea loam, 2 to 5 percent slopes	2.67	1.7%		**174	**54	**129
<b>Weighted Average</b>					<b>165.8</b>	<b>53.2</b>	<b>122.3</b>

**Table: Optimum Crop Productivity Ratings for Illinois Soil by K.R. Olson and J.M. Lang, Office of Research, ACES, University of Illinois at Champaign-Urbana.** Version: 1/2/2012 Amended Table S2 B811

Crop yields and productivity indices for optimum management (B811) are maintained at the following NRES web site: <http://soilproductivity.nres.illinois.edu/>

\*\* Indexes adjusted for slope and erosion according to Bulletin 811 Table S3

Soils data provided by USDA and NRCS. Soils data provided by University of Illinois at Champaign-Urbana.