

Soils Map

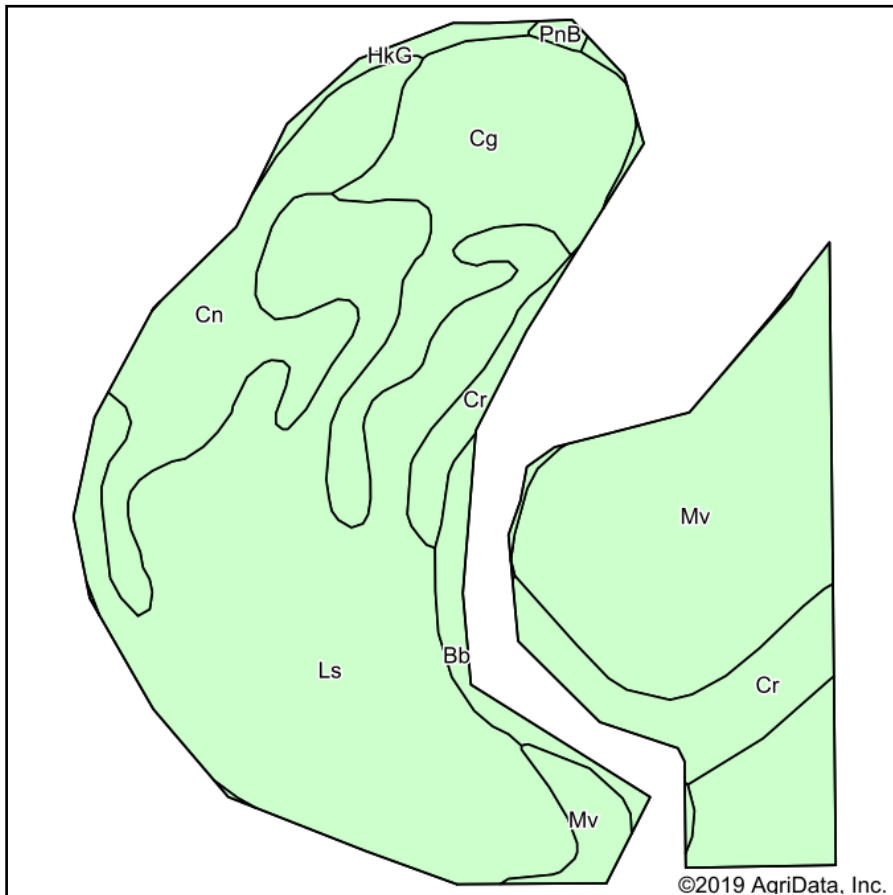

Soils data provided by USDA and NRCS.

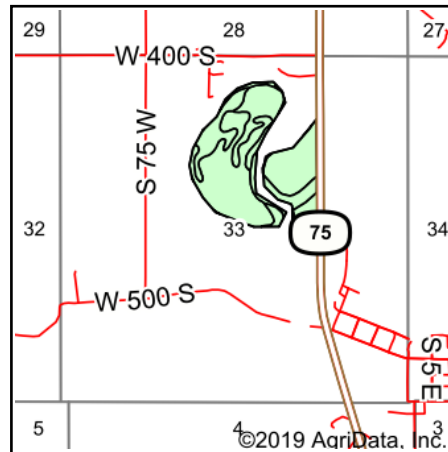

State: **Indiana**
 County: **Carroll**
 Location: **33-24N-1W**
 Township: **Democrat**
 Acres: **64.49**
 Date: **8/21/2019**

Maps Provided By:

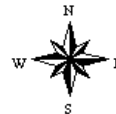

Area Symbol: IN015. Soil Area Version: 23							
Code	Soil Description	Acres	Percent of field	Non-Irr Class	Corn	Soybeans	*n NCCPI Overall
Ls	Landes-Moundhaven complex, occasionally flooded	25.49	39.5%	IIw	84	27	56
Mv	Moundhaven-Landes variant complex, frequently flooded	16.42	25.5%	IIIw	73	24	37
Cg	Ceresco fine sandy loam, occasionally flooded	8.38	13.0%	IIw	108	28	70
Cn	Cohoctah loam, occasionally flooded	6.96	10.8%	IIw	135	28	72
Cr	Cohoctah variant very fine sandy loam, frequently flooded	4.73	7.3%	IIIw	120	23	46
Bb	Beaucoup silt loam, frequently flooded	1.66	2.6%	IVw	150	40	65
HkG	Hennepin loam, 25 to 50 percent slopes	0.67	1.0%	VIIe	14	5	10
PnB	Piankeshaw variant gravelly sandy loam, rarely flooded, 2 to 8 percent slopes	0.18	0.3%	IVs	97	29	44
Weighted Average					93.5	26.3	*n 53.7

*n: The aggregation method is "Weighted Average using major components"
 Soils data provided by USDA and NRCS.