

# Soils Map

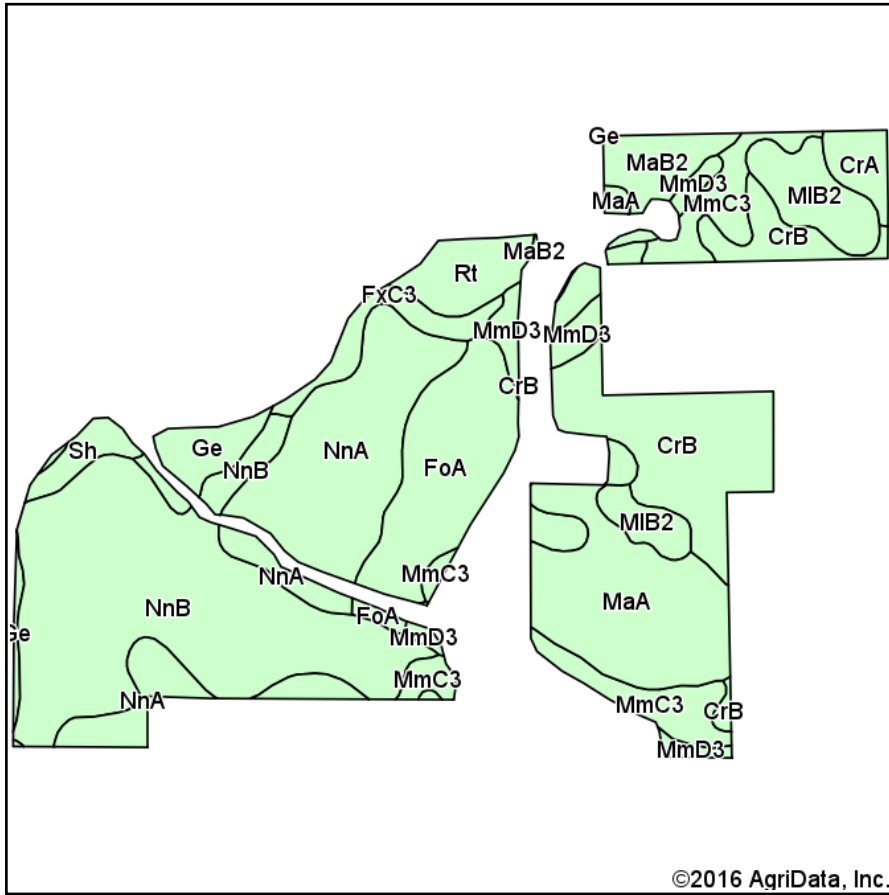

Soils data provided by USDA and NRCS.

## SOIL MAP

### The Hey Trust 187 Acre Land Auction

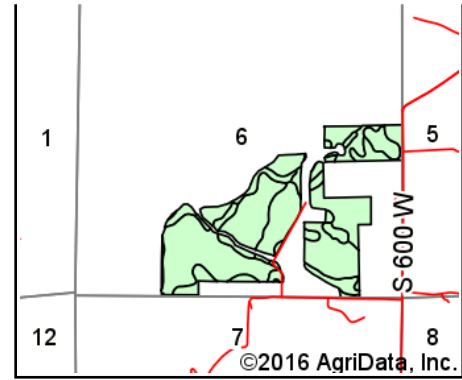

State: **Indiana**  
 County: **Shelby**  
 Location: **6-11N-6E**  
 Township: **Jackson**  
 Acres: **136.59**  
 Date: **10/18/2016**

Maps Provided By:



© AgriData, Inc. 2016

www.AgriDataInc.com



#### Area Symbol: IN145, Soil Area Version: 19

Code	Soil Description	Acres	Percent of field	Non-Irr Class	Corn	Soybeans
NnB	Nineveh loam, 2 to 6 percent slopes	33.26	24.4%	Ile	110	35
NnA	Nineveh loam, 0 to 2 percent slopes	21.38	15.7%	Ils	110	35
CrB	Crosby silt loam, 2 to 4 percent slopes	16.94	12.4%	Ile	135	45
MaA	Martinsville loam, 0 to 2 percent slopes	14.58	10.7%	I	145	51
FoA	Fox loam, 0 to 2 percent slopes	12.03	8.8%	Ils	106	37
MmC3	Miami clay loam, 6 to 12 percent slopes, severely eroded	9.95	7.3%	IVe	121	41
MIB2	Miami silt loam, 2 to 6 percent slopes, eroded	6.55	4.8%	Ile	142	49
Rt	Ross silt loam	3.93	2.9%	Ilw	145	46
MmD3	Miami clay loam, 12 to 18 percent slopes, severely eroded	3.85	2.8%	Vle	110	39
Ge	Genesee loam	3.65	2.7%	Ilw	130	46
MaB2	Martinsville loam, 2 to 6 percent slopes, eroded	3.43	2.5%	Ile	140	49
FxC3	Fox clay loam, 6 to 12 percent slopes, severely eroded	2.95	2.2%	IVe	80	28
CrA	Crosby silt loam, 0 to 2 percent slopes	2.23	1.6%	Ilw	138	46
Sh	Shoals silt loam, 0 to 2 percent slopes, frequently flooded, very brief duration	1.86	1.4%	Ilw	129	42
<b>Weighted Average</b>					<b>121.2</b>	<b>40.4</b>

Area Symbol: IN145, Soil Area Version: 19

Soils data provided by USDA and NRCS.